

CP18765\_YASMEEN-70-ZOOM-C2  
 CP18779\_YASMEEN-70-ZOOM-C2-WHT

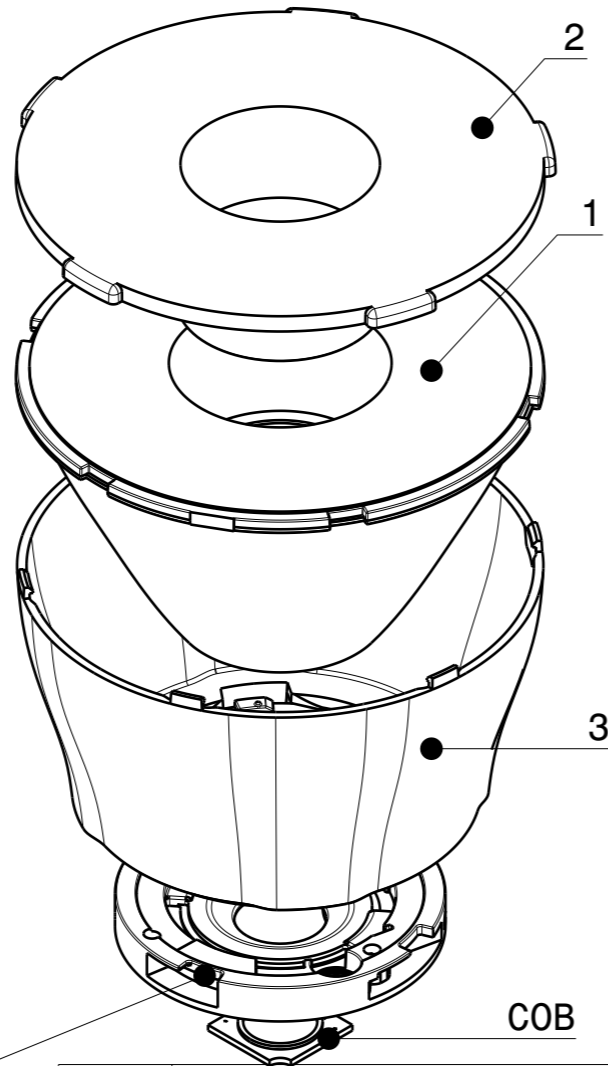

CP18772\_YASMEEN-70-ZOOM-B2  
 CP18786\_YASMEEN-70-ZOOM-B2-WHT

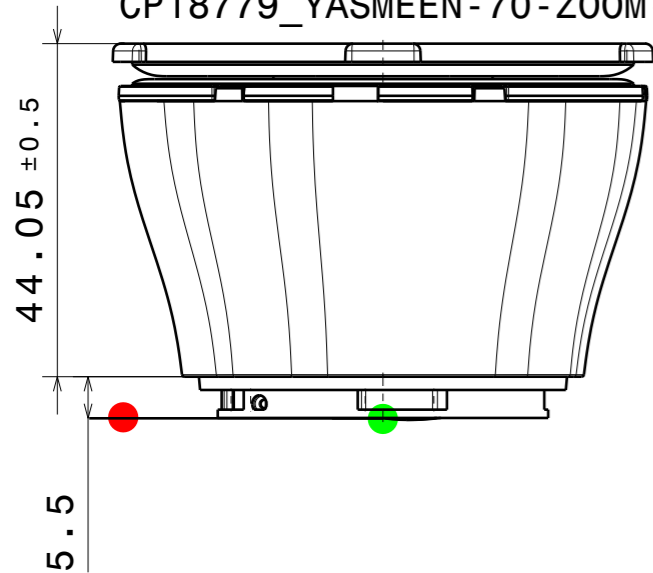
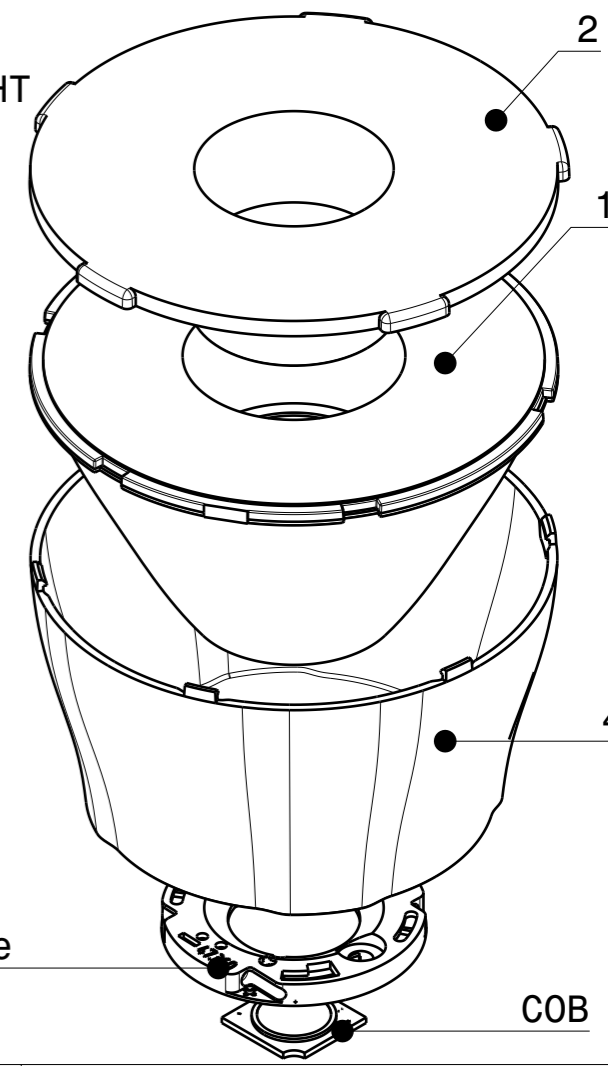
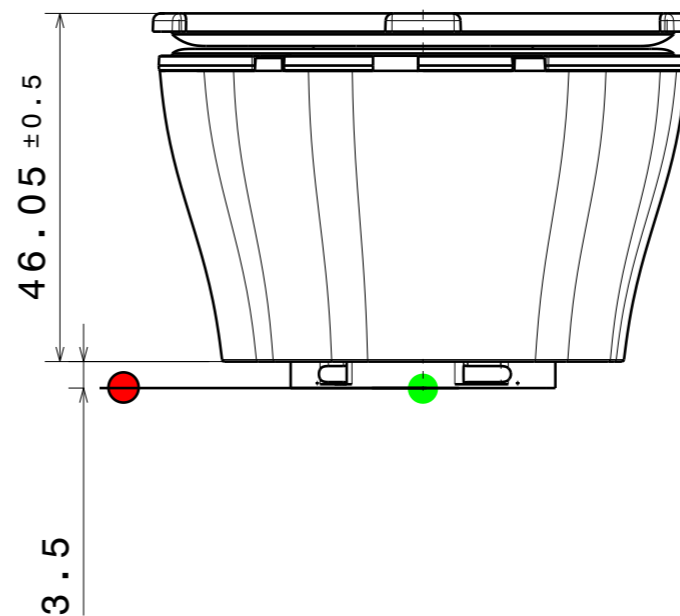

Connector  
 BJB / B+W 35mm-interface

HEKLA  
 Connector

COB

COB

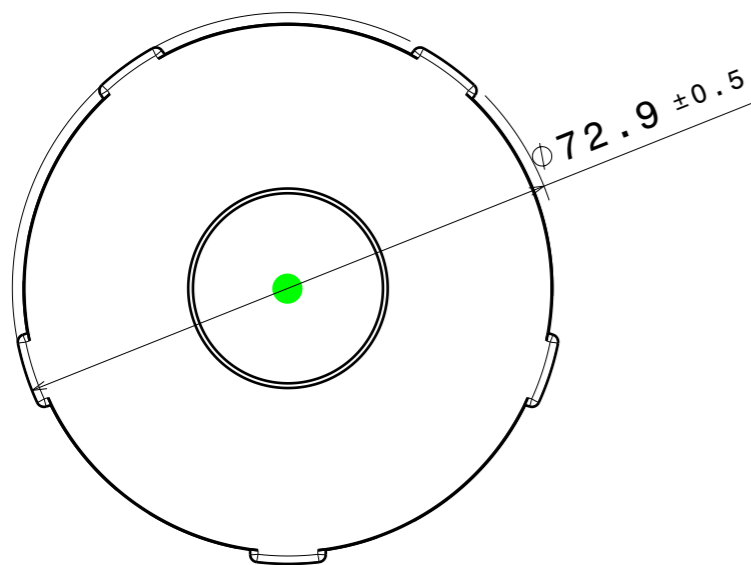

Top view  
 Scale: 1:1

| INDEX | PART                           | TYPE    | QTY | MATERIAL | COLOUR/COATING | ASSEMBLY CODES                  |
|-------|--------------------------------|---------|-----|----------|----------------|---------------------------------|
| 1     | C17741_YASMEEN-70-ZOOM         | LENS    | 1   | PMMA     | CLEAR          |                                 |
| 2     | C17736_YASMEEN-70-ZOOM-SUB     | SUBLENS | 1   | PMMA     | CLEAR          |                                 |
| 3     | HOLDER C                       | HOLDER  | 1   |          |                |                                 |
|       | C18692_YASMEEN-70-HLD2-C       |         |     | PC       | BLACK          | CP18765_YASMEEN-70-ZOOM-C2      |
|       | C18700_YASMEEN-70-HLD2-C-WHT   |         |     | PC       | WHITE          | CP18779_YASMEEN-70-ZOOM-C2-WHT  |
| 4     | HOLDER B                       |         |     |          |                |                                 |
|       | C18693_YASMEEN-70-HLD2-B       |         |     | PC       | BLACK          | CP18772_YASMEEN-70-ZOOM-B2      |
|       | C18701_YASMEEN-70-HLD2-B-WHT   |         |     | PC       | WHITE          | CP18786_YASMEEN-70-ZOOM-B2-WHT  |
| 5     | HOLDER B50                     |         |     |          |                |                                 |
|       | C19945_YASMEEN-70-HLD2-B50     |         |     | PC       | BLACK          | CP19961_YASMEEN-70-ZOOM-B50     |
|       | C19946_YASMEEN-70-HLD2-B50-WHT |         |     | PC       | WHITE          | CP19968_YASMEEN-70-ZOOM-B50-WHT |

**MECHANICAL DRAWING**

PRODUCT  
**YASMEEN-70-ZOOM**

Plastic moulding general tolerances according to DIN 16901-130 and applies if not otherwise shown in the drawing.  
 Silicone moulding general tolerances according to ISO 3302-1 Class M3 and applies if not otherwise shown in the drawing.

FIRST ANGLE PROJECTION:

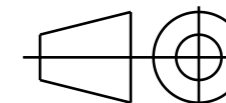

**LEDiL**

This drawing is the property of LEDiL Oy. It may not be copied or otherwise distributed without prior written permission from LEDiL Oy.

SCALE 1:1

WEIGHT -

A3 SHEET 1/5

**Notes**

- PCB or heatsink level.
- LED location
- Ensure LED fitting from a product specific 3D model available from [www.ledil.com](http://www.ledil.com)
- For more details about installation please see LEDiL Installation Guide on [www.ledil.com](http://www.ledil.com)

H G F E D C B A

CP19961\_YASMEEN-70-ZOOM-B50  
 CP19968\_YASMEEN-70-ZOOM-B50-WHT

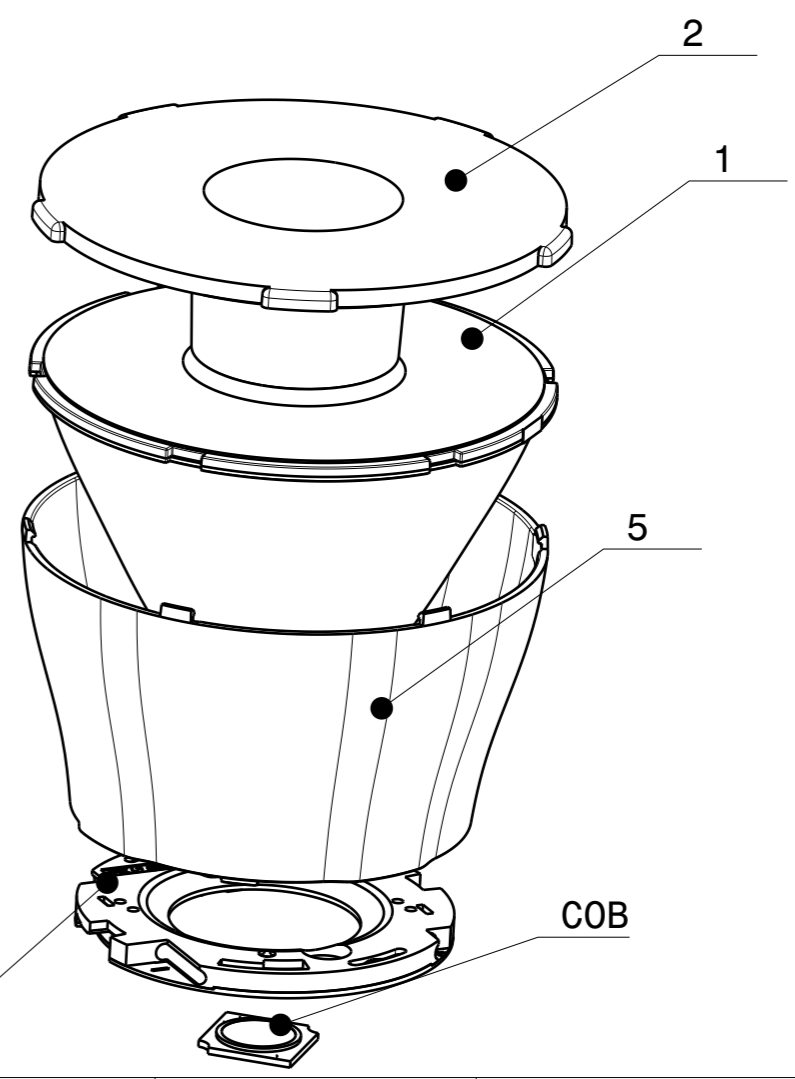
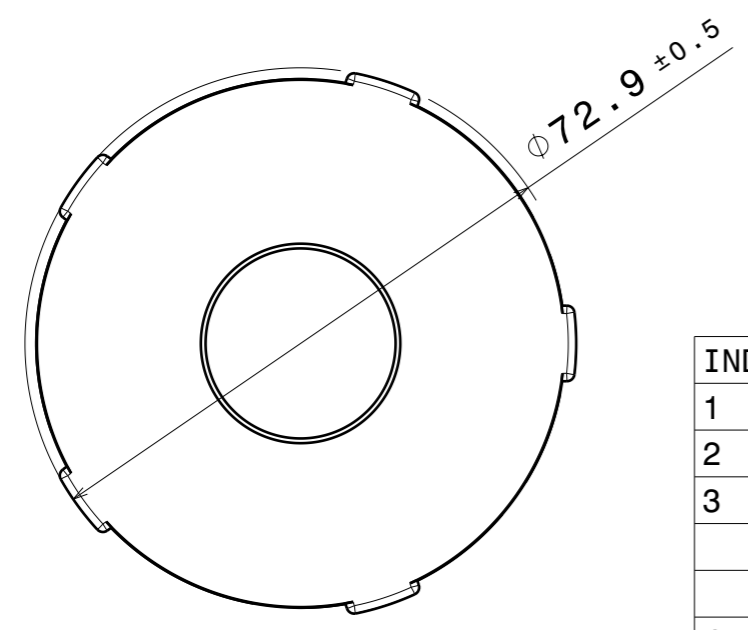
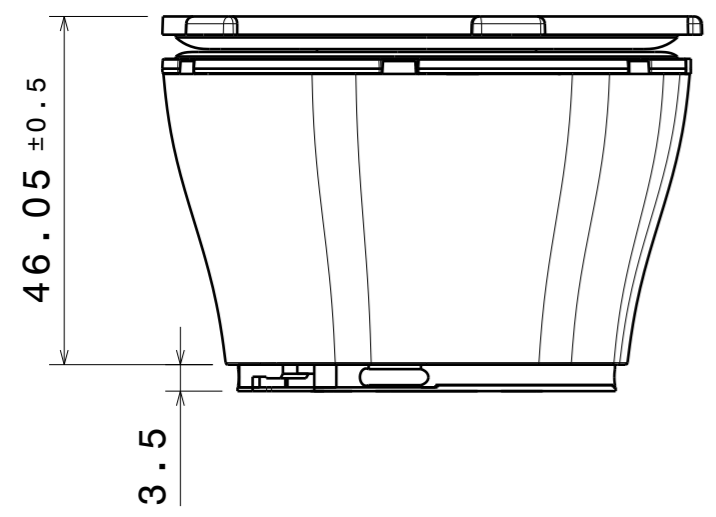

Connector  
 BJB B50/ B+W 50mm-interface

| INDEX | PART                           | TYPE    | QTY | MATERIAL | COLOUR/COATING | ASSEMBLY CODES                  |
|-------|--------------------------------|---------|-----|----------|----------------|---------------------------------|
| 1     | C17741_YASMEEN-70-ZOOM         | LENS    | 1   | PMMA     | CLEAR          |                                 |
| 2     | C17736_YASMEEN-70-ZOOM-SUB     | SUBLENS | 1   | PMMA     | CLEAR          |                                 |
| 3     | HOLDER C                       | HOLDER  | 1   |          |                |                                 |
|       | C18692_YASMEEN-70-HLD2-C       |         |     | PC       | BLACK          | CP18765_YASMEEN-70-ZOOM-C2      |
|       | C18700_YASMEEN-70-HLD2-C-WHT   |         |     | PC       | WHITE          | CP18779_YASMEEN-70-ZOOM-C2-WHT  |
| 4     | HOLDER B                       |         |     |          |                |                                 |
|       | C18693_YASMEEN-70-HLD2-B       |         |     | PC       | BLACK          | CP18772_YASMEEN-70-ZOOM-B2      |
|       | C18701_YASMEEN-70-HLD2-B-WHT   |         |     | PC       | WHITE          | CP18786_YASMEEN-70-ZOOM-B2-WHT  |
| 5     | HOLDER B50                     |         |     |          |                |                                 |
|       | C19945_YASMEEN-70-HLD2-B50     |         |     | PC       | BLACK          | CP19961_YASMEEN-70-ZOOM-B50     |
|       | C19946_YASMEEN-70-HLD2-B50-WHT |         |     | PC       | WHITE          | CP19968_YASMEEN-70-ZOOM-B50-WHT |

**MECHANICAL DRAWING**

PRODUCT  
**YASMEEN-70-ZOOM**

Plastic moulding general tolerances according to DIN 16901-130 and applies if not otherwise shown in the drawing.  
 Silicone moulding general tolerances according to ISO 3302-1 Class M3 and applies if not otherwise shown in the drawing.

FIRST ANGLE PROJECTION:

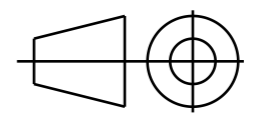

SCALE 1:1

WEIGHT -

**LEDiL**

This drawing is the property of LEDiL Oy. It may not be copied or otherwise distributed without prior written permission from LEDiL Oy.

A3 SHEET 2/5

**Notes**

- PCB or heatsink level.
- LED location
- Ensure LED fitting from a product specific 3D model available from [www.ledil.com](http://www.ledil.com)
- For more details about installation please see LEDiL Installation Guide on [www.ledil.com](http://www.ledil.com)

H G B A

Sublens rotate freely.  
 Beam angle changing smoothly.  
 Spot - Wide - Spot- Wide ....

# BEAM ANGLE

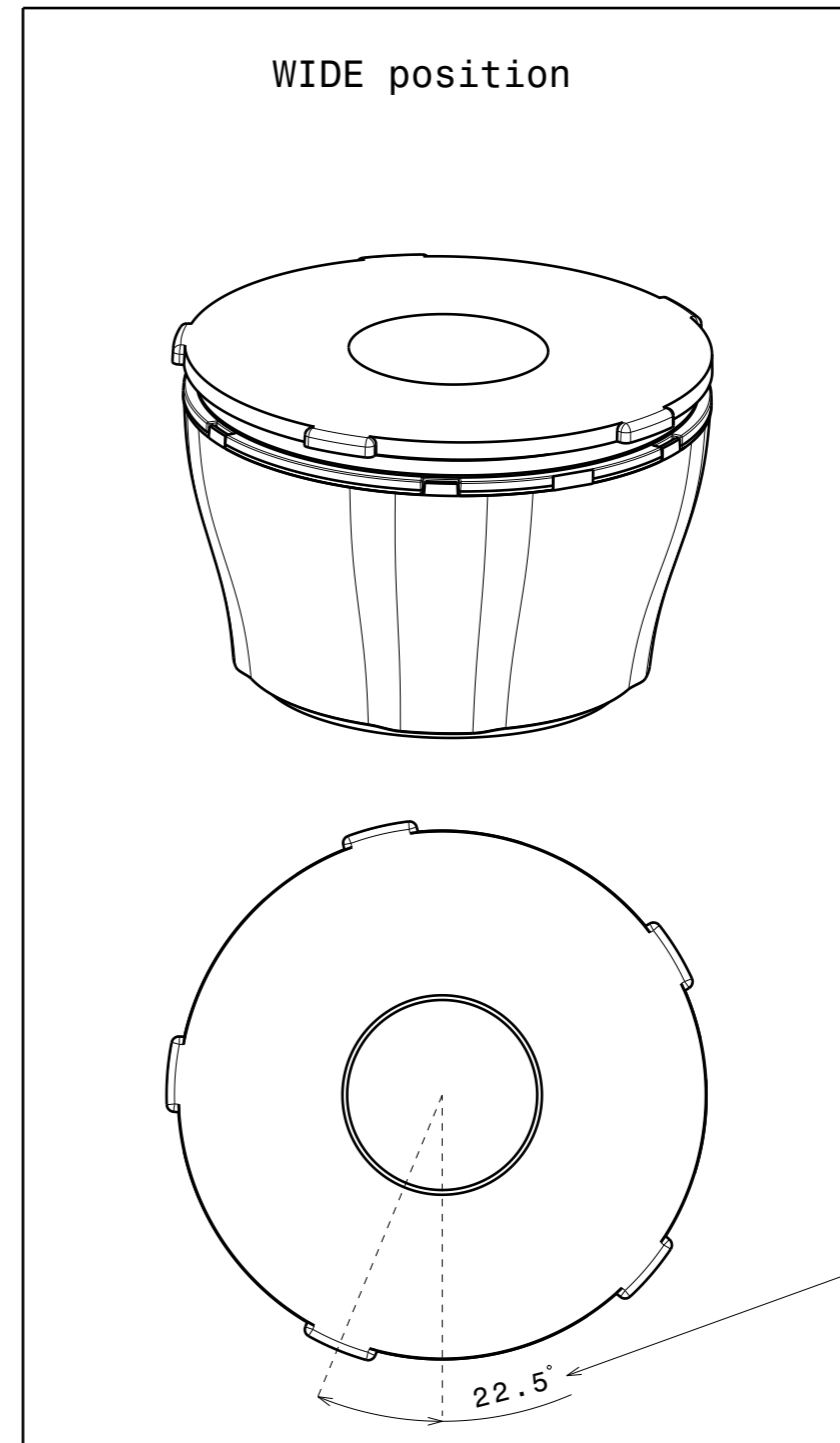
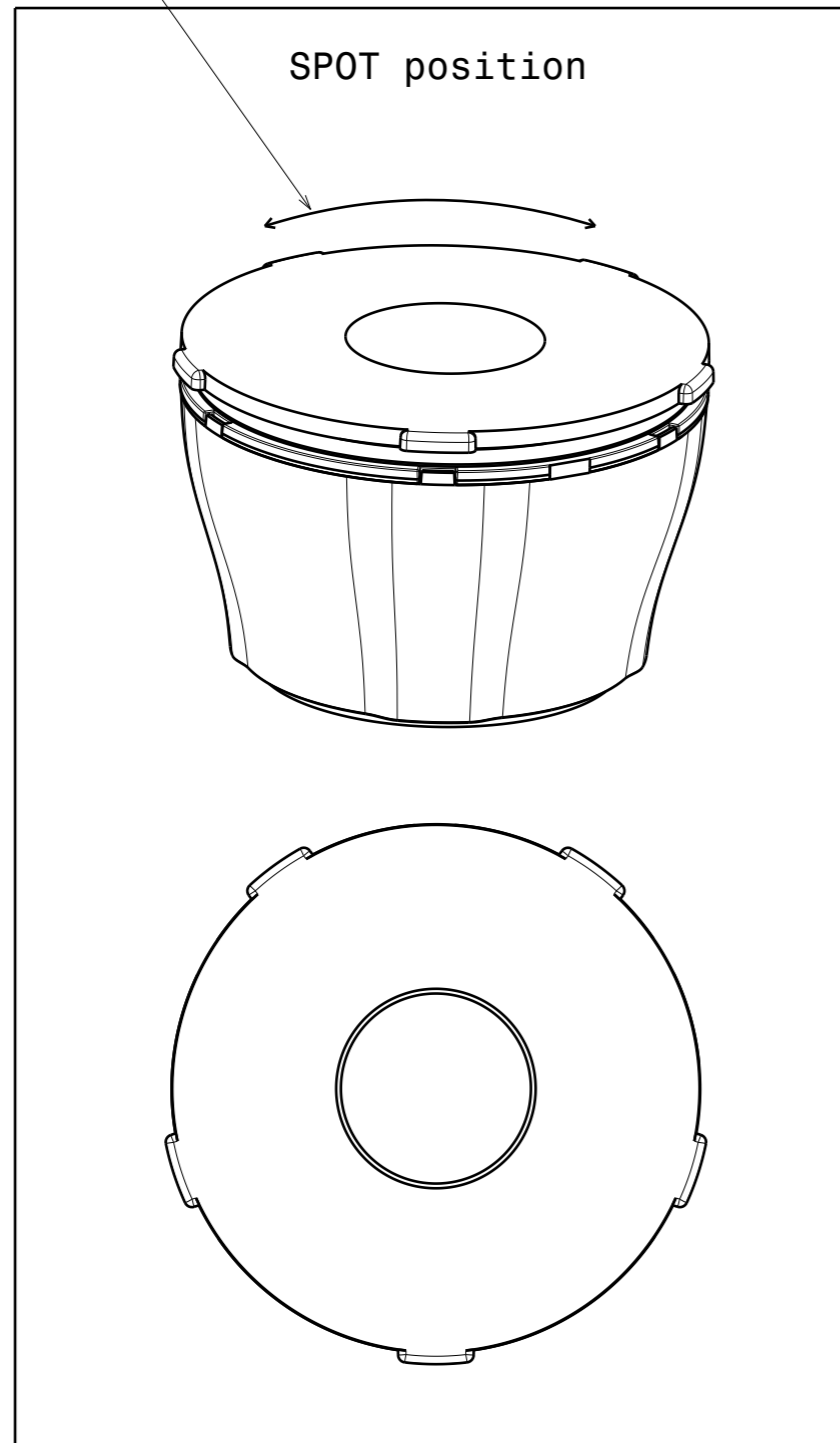

Sub lens rotation  
 angle between spot  
 to wide beam angle

22.5°

|   |                             |   |
|---|-----------------------------|---|
| <b>MECHANICAL DRAWING</b>   |                             | <b>LEDiL</b>  |
| PRODUCT   | <b>YASMEEN-70-ZOOM</b>      |   |
| Plastic moulding general tolerances according to DIN 16901-130 and applies if not otherwise shown in the drawing.<br>Silicone moulding general tolerances according to ISO 3302-1 Class M3 and applies if not otherwise shown in the drawing. | FIRST ANGLE PROJECTION:<br> | This drawing is the property of LEDiL Oy. It may not be copied or otherwise distributed without prior written permission from LEDiL Oy. |
| SCALE   | 1:1                         | WEIGHT -  |
|   |                             | A3 SHEET 3/5  |

**Notes**

- PCB or heatsink level.
- LED location
- Ensure LED fitting from a product specific 3D model available from [www.ledil.com](http://www.ledil.com)
- For more details about installation please see LEDiL Installation Guide on [www.ledil.com](http://www.ledil.com)

H G F E D C B A

4

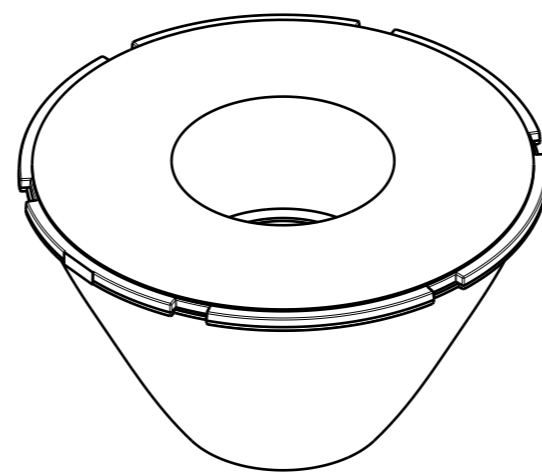
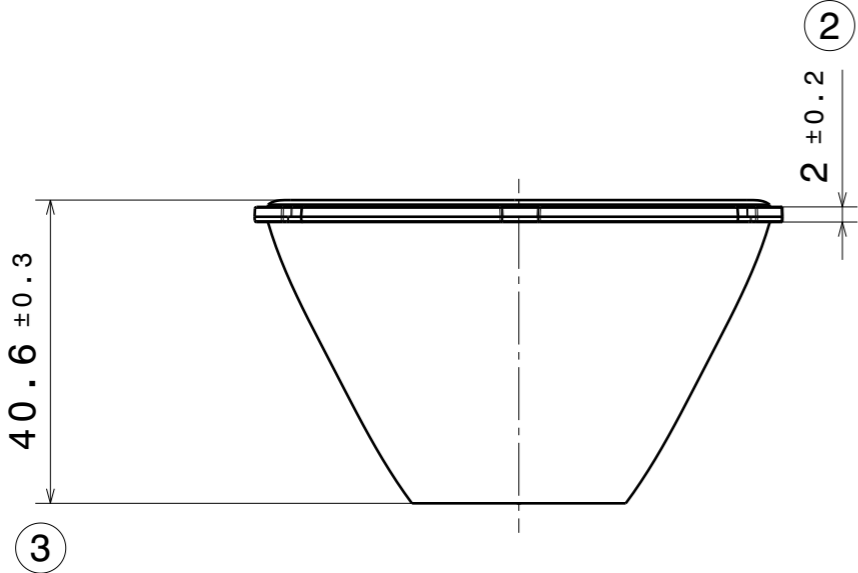

4

3

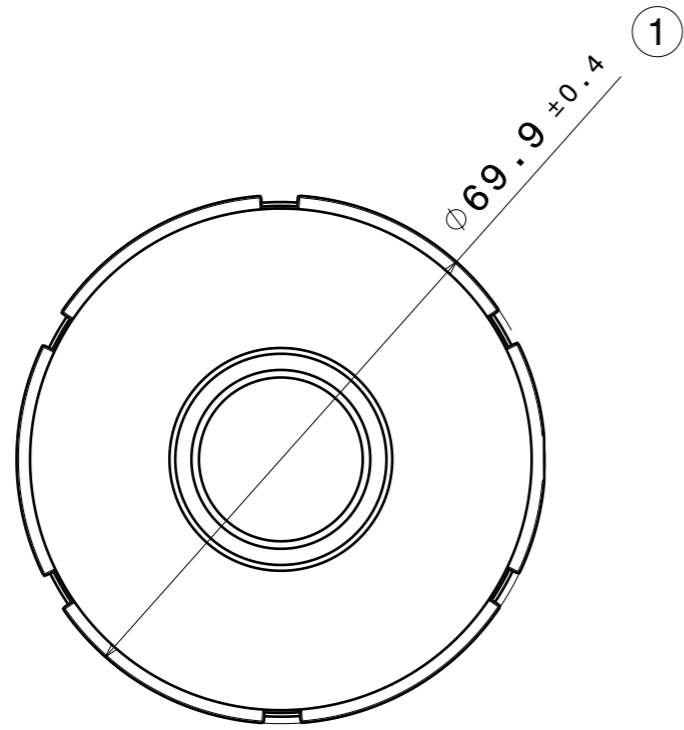

3

2

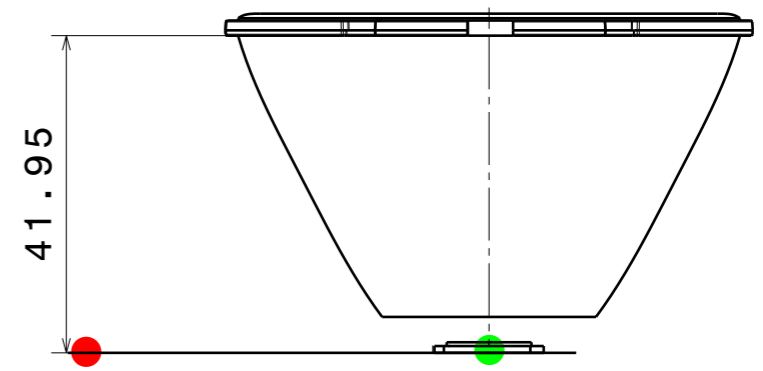

2

1

**Notes**

|  |   |
|--|---|
|  | PCB or heatsink level.  |
|  | LED location  |
|  | Ensure LED fitting from a product specific 3D model available from <a href="http://www.ledil.com">www.ledil.com</a>         |
|  | For more details about installation please see LEDiL Installation Guide on <a href="http://www.ledil.com">www.ledil.com</a> |

|                        |      |          |                 |
|------------------------|------|----------|-----------------|
| PART                   | TYPE | MATERIAL | COLOR / COATING |
| C17741_YASMEEN-70-ZOOM | LENS | PMMA     | CLEAR           |

**MECHANICAL DRAWING**

PRODUCT **YASMEEN-70-ZOOM**



Plastic moulding general tolerances according to DIN 16901-130 and applies if not otherwise shown in the drawing.  
Silicone moulding general tolerances according to ISO 3302-1 Class M3 and applies if not otherwise shown in the drawing.

**FIRST ANGLE PROJECTION:**

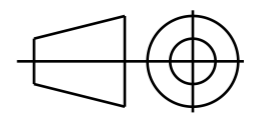

This drawing is the property of LEDiL Oy. It may not be copied or otherwise distributed without prior written permission from LEDiL Oy.

|       |     |        |   |    |           |
|-------|-----|--------|---|----|-----------|
| SCALE | 1:1 | WEIGHT | - | A3 | SHEET 4/5 |
|-------|-----|--------|---|----|-----------|

H G F E D C B A

1

H G F E D C B A

4

3

2

1

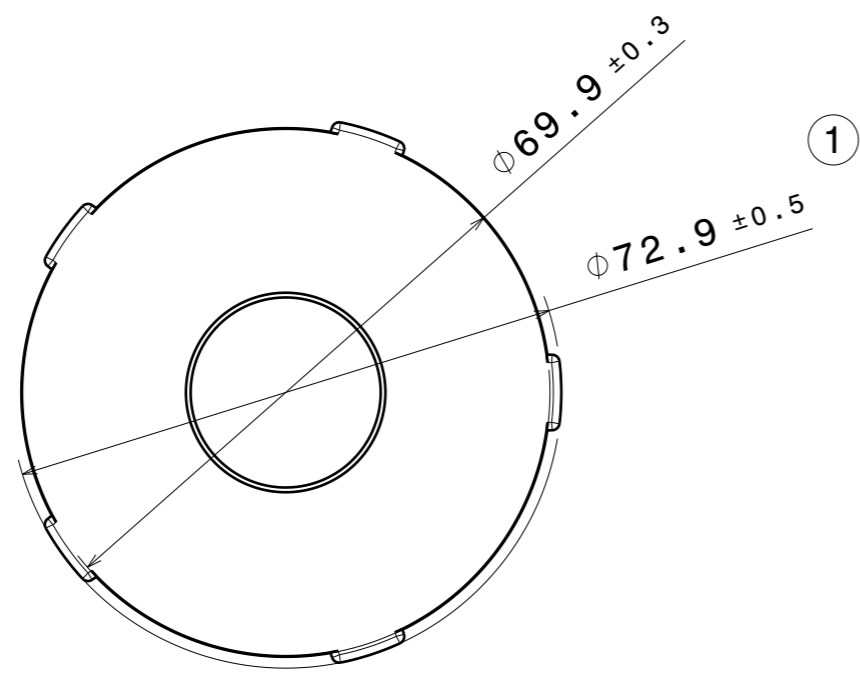
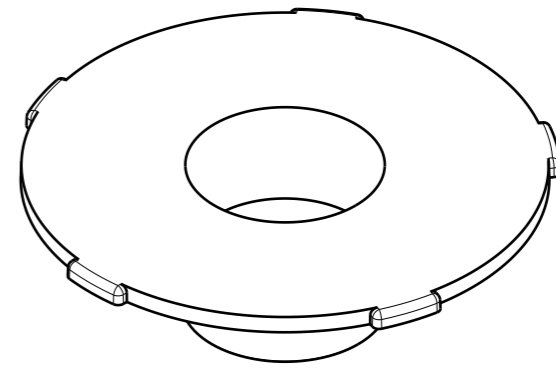
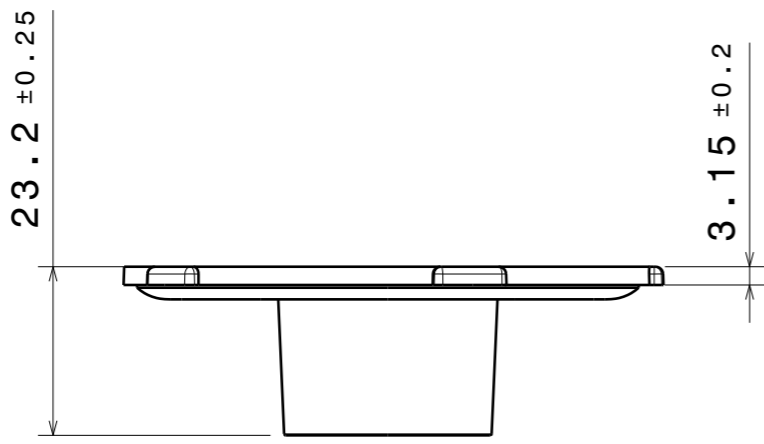

| PART                       | TYPE    | QTY | MATERIAL | COLOUR/COATING |
|----------------------------|---------|-----|----------|----------------|
| C17736_YASMEEN-70-ZOOM-SUB | SUBLENS | 1   | PMMA     | CLEAR          |

**MECHANICAL DRAWING**

PRODUCT **YASMEEN-70-ZOOM**

Plastic moulding general tolerances according to DIN 16901-130 and applies if not otherwise shown in the drawing. Silicone moulding general tolerances according to ISO 3302-1 Class M3 and applies if not otherwise shown in the drawing.

FIRST ANGLE PROJECTION:

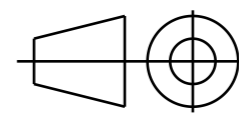

**LEDiL**

This drawing is the property of LEDiL Oy. It may not be copied or otherwise distributed without prior written permission from LEDiL Oy.

|       |     |        |   |    |           |
|-------|-----|--------|---|----|-----------|
| SCALE | 1:1 | WEIGHT | - | A3 | SHEET 5/5 |
|-------|-----|--------|---|----|-----------|

H G B A

4

3

2

1

**Notes**

- PCB or heatsink level.
- LED location
- Ensure LED fitting from a product specific 3D model available from [www.ledil.com](http://www.ledil.com)
- For more details about installation please see LEDiL Installation Guide on [www.ledil.com](http://www.ledil.com)