

REV	DATE
001	23.10.2024

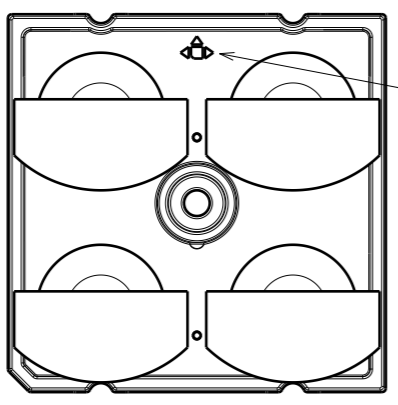

Beam nominal direction

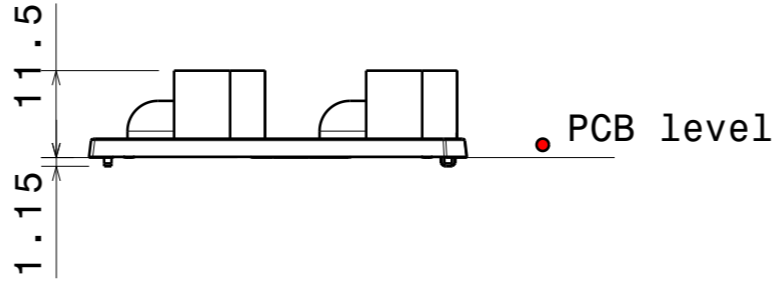
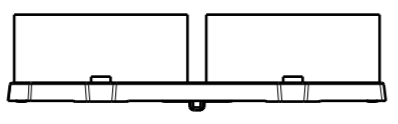
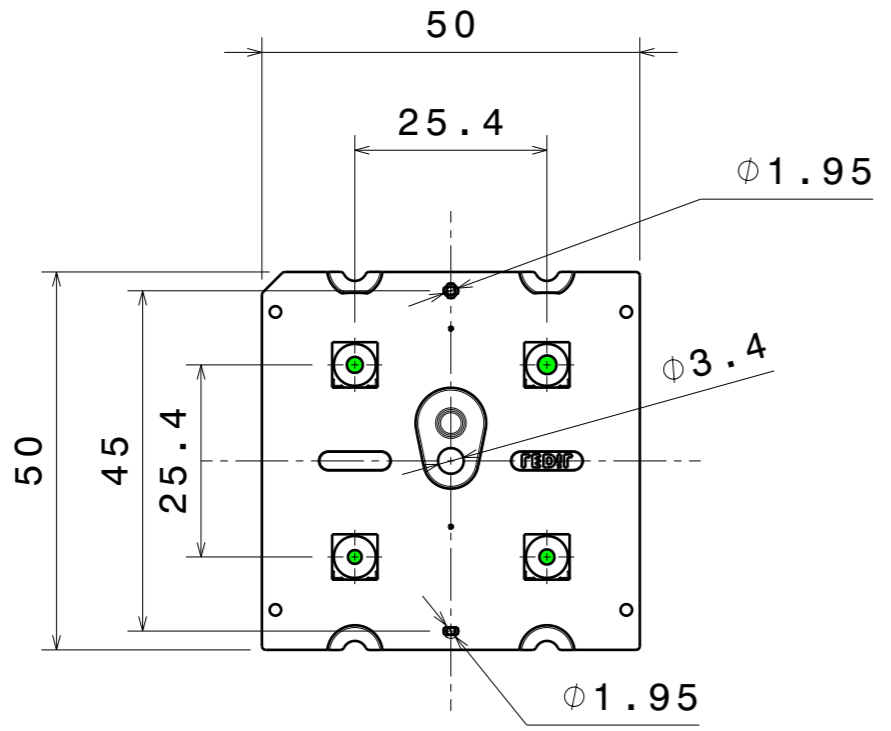
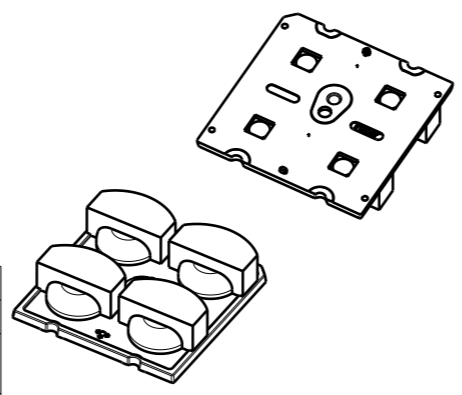

PART	TYPE	MATERIAL	COLOR / COATING
C19975_STRADA-2X2-5050-TF_004_mechanical-model	Lens	PMMA	Clear

MECHANICAL DRAWING

PRODUCT -

Plastic moulding general tolerances according to DIN 16901-130 and applies if not otherwise shown in the drawing. Silicone moulding general tolerances according to ISO 3302-1 Class M3 and applies if not otherwise shown in the drawing.

FIRST ANGLE PROJECTION:

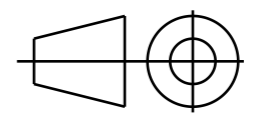

SCALE 1:1

WEIGHT 11.4g

LEDiL

This drawing is the property of LEDiL Oy. It may not be copied or otherwise distributed without prior written permission from LEDiL Oy.

A3 SHEET 1/1

Notes

	PCB or heatsink level.
	LED location
	Ensure LED fitting from a product specific 3D model available from www.ledil.com
	For more details about installation please see LEDiL Installation Guide on www.ledil.com