

REV	DATE
002	30.10.2024

ISO
Scale 1:4

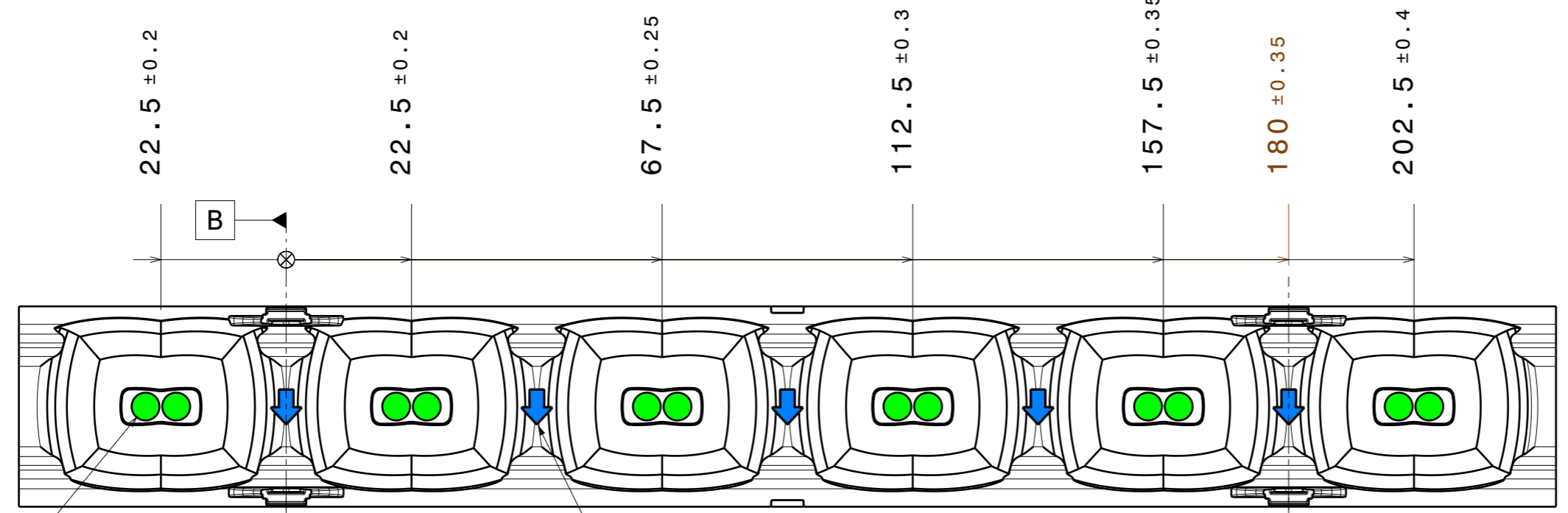
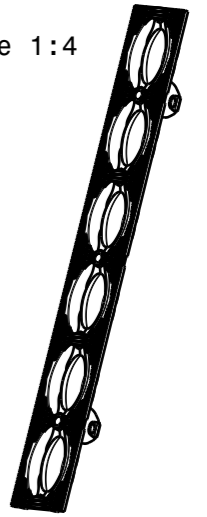

● LED location

Arrow points to the shelf side

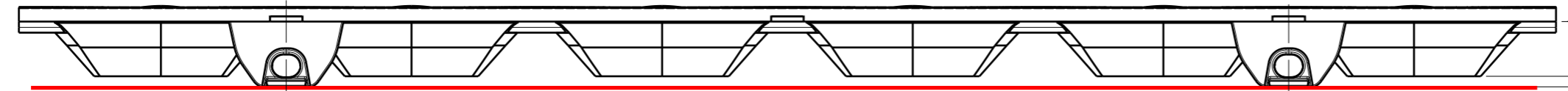

276 ± 0.5

A flange

9.86 ± 0.25

11.76 ± 0.25

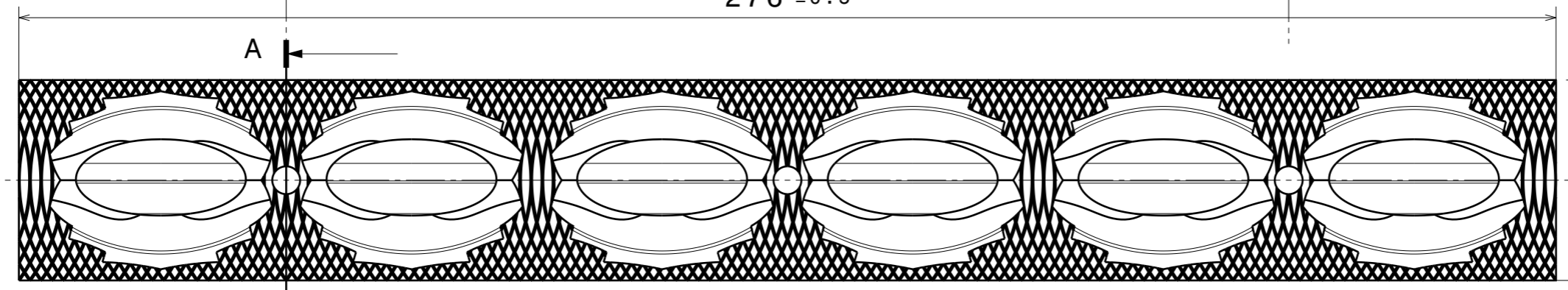

14.35 ± 0.25

10.19 ± 0.25

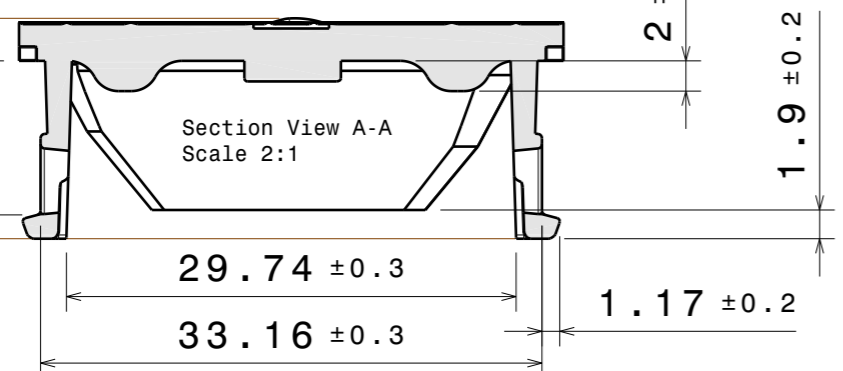

PART	TYPE	MATERIAL	COLOR / COATING
C19298_ISLA-6X1-0A	Lens	PMMA	Clear

MECHANICAL DRAWING

PRODUCT ISLA

LEDiL

Plastic moulding general tolerances according to DIN 16901-130 and applies if not otherwise shown in the drawing. Silicone moulding general tolerances according to ISO 3302-1 Class M3 and applies if not otherwise shown in the drawing.

FIRST ANGLE PROJECTION:

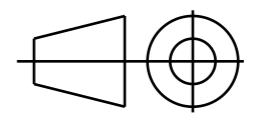

This drawing is the property of LEDiL Oy. It may not be copied or otherwise distributed without prior written permission from LEDiL Oy.

SCALE	1:1	WEIGHT	65,4 g	A3	SHEET 1/1
-------	-----	--------	--------	----	-----------

- Notes**
- Use C18353_BRIANNA-CLIP-A or C18354_BRIANNA-CLIP-B for correct LED/PCB level.
 - LED location
 - Arrow points to the shelf side
 - Ensure LED fitting from a product specific 3D model available from www.ledil.com
 - For more details about installation please see LEDiL Installation Guide on www.ledil.com

REV	DATE
002	30.10.2024

Assembly Example ISLA 6X1 CLIP A

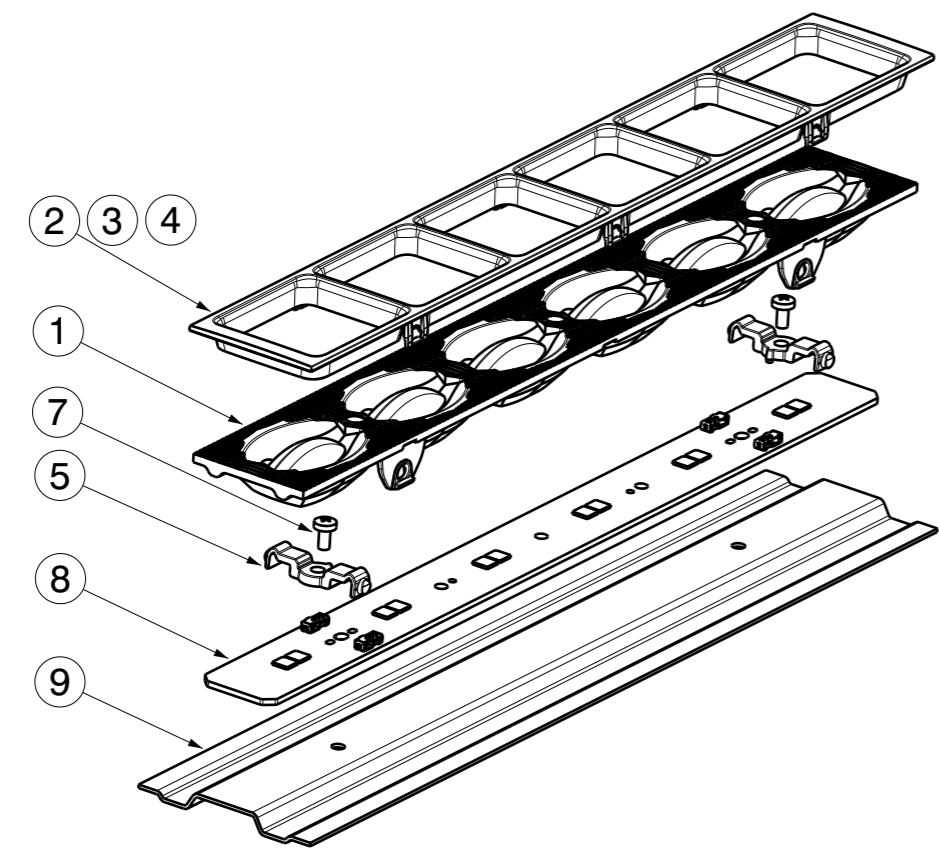

Please Note: If using C18353_BRIANNA-CLIP-A M3 Screws to be used.

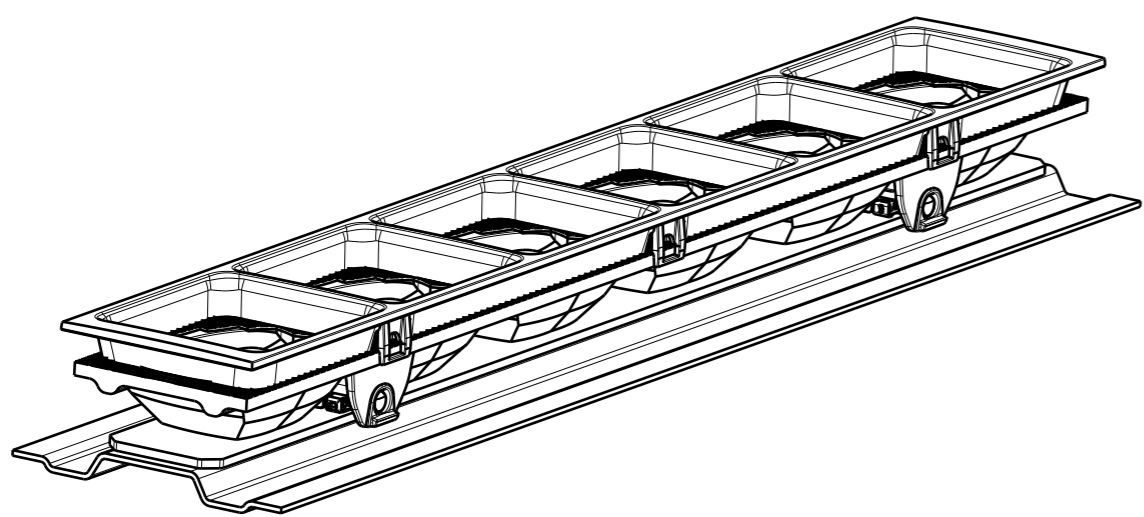

Notes

Part dimensions are the master. Assembly drawing dimensions refer to the sum of the part dimensions.
Ensure clips are fixed in assembly process.
Ensure lens xyz-direction assembly result is stable.

Assembly Example ISLA 6X1 CLIP B

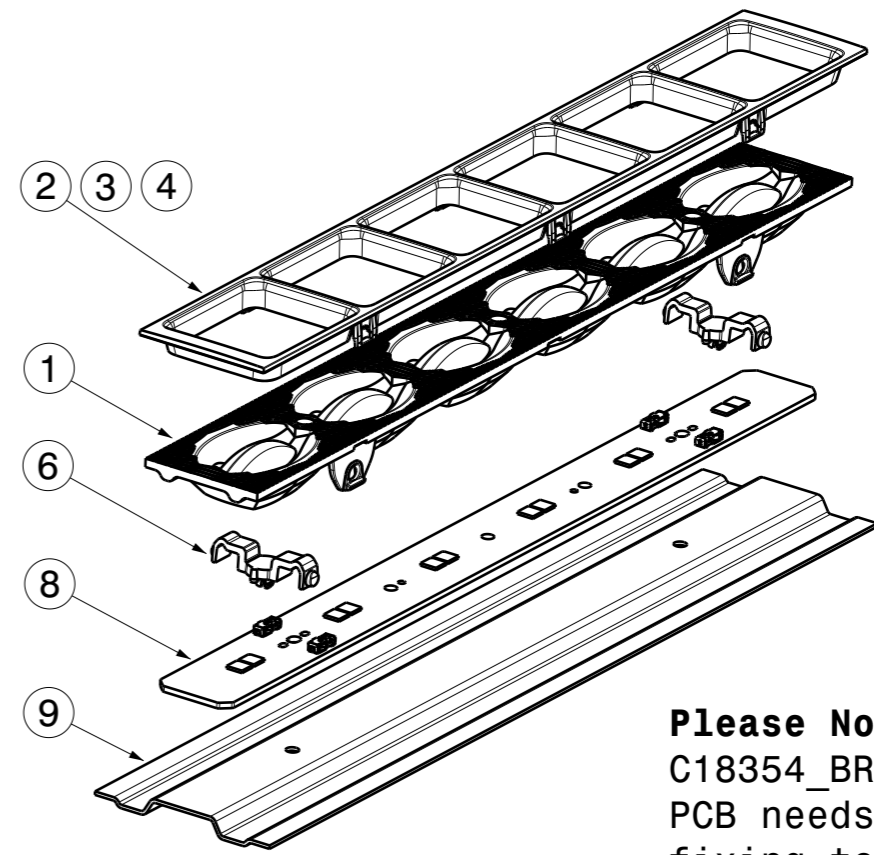

Please Note: If using C18354_BRIANNA-CLIP-B, PCB needs separate fixing to the housing for example screws.

COMPONENTS

INDEX	PART	TYPE	COUNT	MATERIAL	COLOR
1	C19298_ISLA-6X1-0A	LENS	1	PMMA	clear
2	C19299_ISLA-6X1-SHD	Accessory	1	PC	black
3	C19426_ISLA-6X1-SHD-MET	Accessory	1	PC	metal, glossy
4	C19520_ISLA-6X1-SHD-WHT	Accessory	1	PC	white
5	C18353_BRIANNA-CLIP-A	Accessory	2	PC	clear
6	C18354_BRIANNA-CLIP-B	Accessory	2	PC	clear
7	M3 Screw	Screw	2		
8	Example PCB	PCB	1		
9	Example 1mm Sheetmetal	Sheetmetal	1		

MECHANICAL DRAWING		LEDiL
FAMILY ISLA		
Plastic moulding general tolerances according to DIN 16901-130 and applies if not otherwise shown in the drawing. Silicone moulding general tolerances according to ISO 3302-1:2014(E)-M2 and applies if not otherwise shown in the drawing.	FIRST ANGLE PROJECTION: 	This drawing is the property of LEDiL Oy. It may not be copied or otherwise distributed without prior written permission from LEDiL Oy.
SCALE 1:2	WEIGHT -	A3 SHEET 1/1